

PRINTABLE INFO SHEET

Series: Pinecrest Modular Ranch

Model: PG252A



About This Model

Style: Ranch / Bedrooms: 3 / Bathrooms: 2 / Square Feet: 1600

CUSTOMER CONTACT

Notes: _____

PRINTABLE INFO SHEET

Series: Pinecrest Modular Ranch
 Model: PG252A



Floorplan

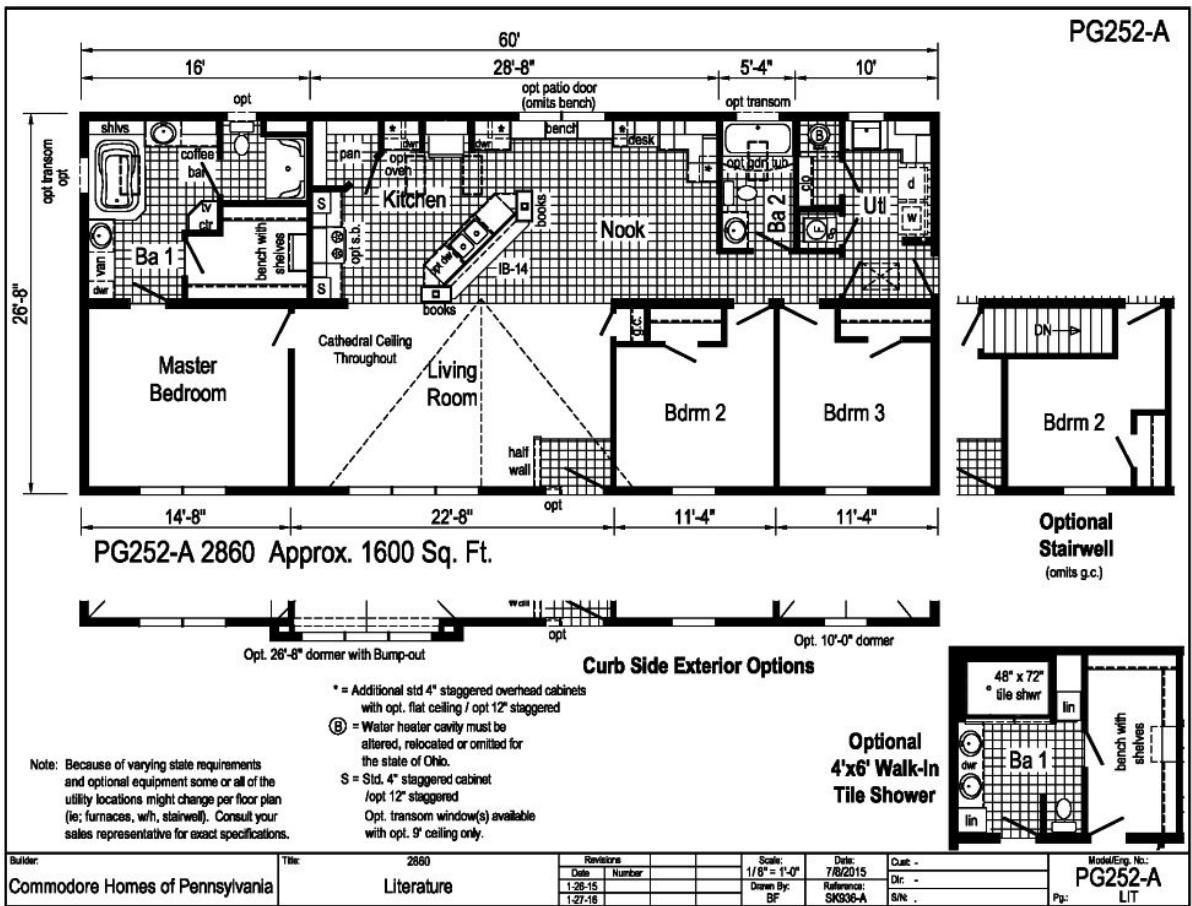

CUSTOMER CONTACT

Notes:

PRINTABLE INFO SHEET

Series: Pinecrest Modular Ranch
 Model: PG252A



Floorplan

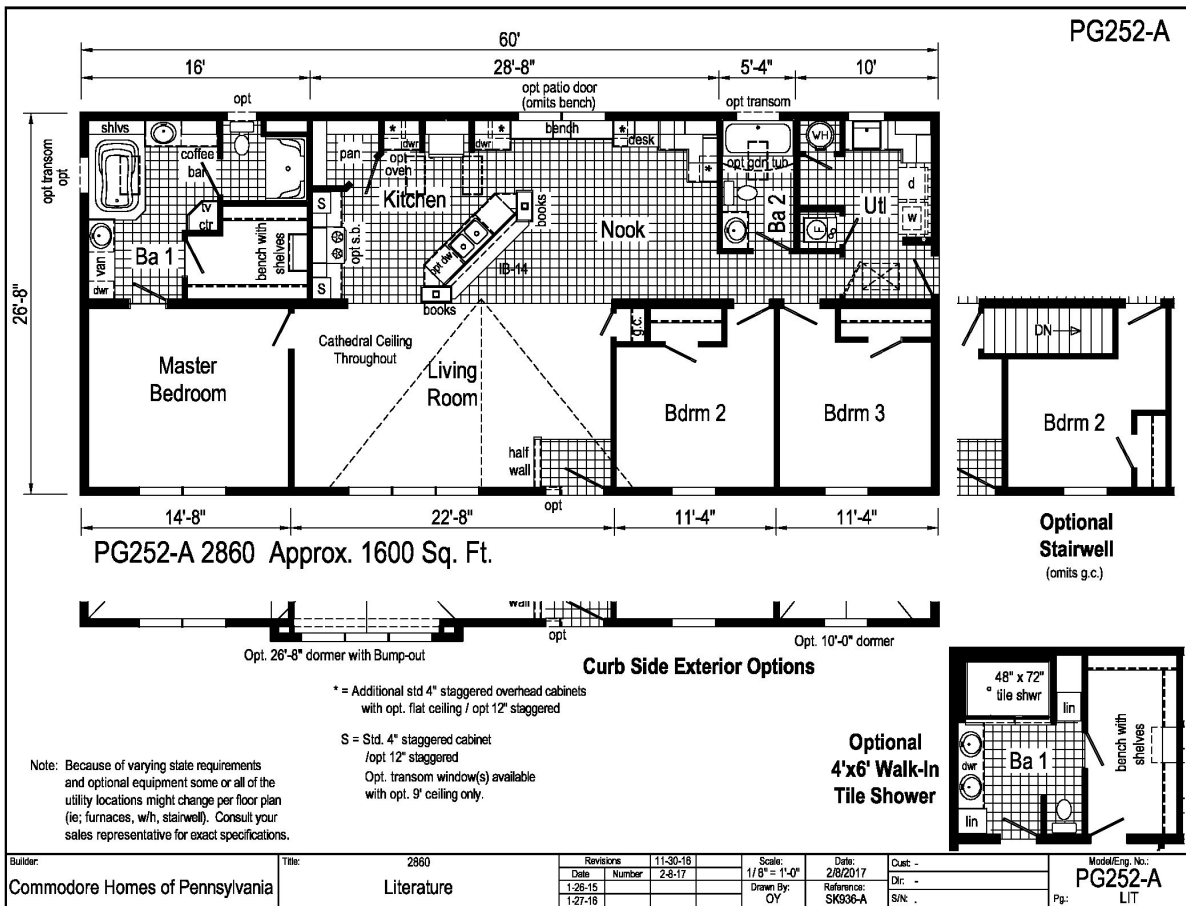

CUSTOMER CONTACT

Notes:

PRINTABLE INFO SHEET

Series: Pinecrest Modular Ranch

Model: PG252A



Standards & Features

INTERIOR

- Primed Smooth Drywall Throughout
- Cathedral Ceiling Throughout
- Stipple Ceiling
- 7'6" Sidewall Height
- Langford 5-Arm Brushed Nickel Dining Room Light
- 3-Arm Light with Alabaster Glass in Nook
- Glass Light Shades Throughout
- Pre-Hung Door Jambs
- Pinned Mortise Hinges
- Metal Interior Passage Sets
- Floor Mount Door Stops
- Smoke Detectors With Battery Back-Up
- Wire Shelving in Guest Closet
- 6-Panel White Interior Doors

EXTERIOR

- White Aluminum Light at Front and Rear Door
- Two GFI-Protected Exterior Receptacles
- Vinyl Dutch Lap Siding
- O.S.B. Sheathing Under Siding
- Wind Wrap Air Infiltration Barrier
- 5/12 Pitch Shingle Roof with 10" Eaves
- Architectural Shingles
- Ridgevent Roof Ventilation System
- Ice Shield
- 38x82 Steel 9-Panel Front Door with Lever Passage Set and Deadbolt Lock
- 34x82 Steel 6-Panel Inswing Rear Door with Deadbolt Lock
- Vinyl Insulated Windows With Grids

EXTERIOR (continued)

- and Low-E Glass
- 12" Raised Panel Shutters on Front Door Side

CONSTRUCTION

- 2x10 Transverse Floor System on 16" Centers**
- 2x6 Exterior Walls on 16" Centers**
- 2x4 Interior Walls
- 40# Roof Load
- 90 Mile Exposure C Wind Load Design
- 3/4" OSB T&G Floor Decking

KITCHEN

- 30" Gas Range
- Power Range Hood with Light
- 18 Cubic Foot, No-Frost Refrigerator
- Stainless Steel Sink - 33x22x8
- Huntington Brass Brushed Nickel Single Lever Faucets

BATHS

- 60" One-Piece Fiberglass Tub/Showers with Tub Surround Trim
- Fiberglass Glamour Tub in Glamour Baths
- One-Piece Fiberglass Shower with Glass Door in Glamour Baths
- Tub Overflows
- 1.6 Gallon Per Flush Elongated Toilets
- China Stool, Tank and Lid
- China Sinks with Pop-Up Drains
- Huntington Brass Brushed Nickel Faucets
- Anti-Scald Valves on Showers

CUSTOMER CONTACT

Notes:

PRINTABLE INFO SHEET

Series: Pinecrest Modular Ranch

Model: PG252A



Standards & Features (continued)

BATHS (continued)

Lighted Vent Fan in Each Bath
Langford 2-Bulb Vanity Light in All Baths

CABINETRY

Classic Craft Cabinetry (KCMA Approved)
Hardwood Mission Flat Panel Cabinet Doors
Hardwood Stiles
Upgrade Cabinet Hardware
Concealed Cabinet Hinges
Hardwood Crown Moulding on Overhead Cabinets
Under Cabinet Moulding
30" Staggered Height Overhead Cabinets on Select Models
Lined Overhead Cabinets
Adjustable Shelves in Overhead Cabinets
Undermount Drawer Guides
Adjustable Center Shelf in Base Cabinets
Drawer Over Door Base Cabinets
Extended Sink Cabinet on Select Models
Laminate Countertops with Crescent Laminate Edging
4" Laminate Backsplash
Base Shelf in Vanities
36" High Master Vanity
33" High Secondary Vanities

UTILITIES

Washer and Dryer Area
- Plumb and Wire for Washer Including Quarter Turn Valve

UTILITIES (continued)

- Wire and Vent for Dryer
200 AMP Electrical Service
Copper Wiring Throughout
40 Gallon Electric Water Heater with Pan Programmable Thermostat
95 Plus High Efficiency Gas Furnace
White 6-Panel Furnace Door
Perimeter Heat System
Air Return System in Ceiling
Fiberglass Heat Ducts
Main Water Line Shut-Off Valve
Water Shut-Off Valves Where Accessible
One Exterior Water Faucet

FLOORING

Downtown/River's Edge Carpet with Rebond Pad
Throughout Except Kitchen, Bathrooms & Utility Room
Rebond Carpet Pad with Tackstrip Carpet Installation
No-Wax LuxFlor Vinyl Floor Coverings by Congoleum, including Foyer

BEDROOMS

Ceiling Lights
Egress Window Each Bedroom
Wire Shelving in Wardrobes
Interior 6-Panel White Passage Doors
Switched 4" LED Light in All Walk-In Closets

INSULATION

R-19 Fiberglass Insulation in Walls

CUSTOMER CONTACT

Notes:

PRINTABLE INFO SHEET

Series: Pinecrest Modular Ranch

Model: PG252A



Standards & Features (continued)

INSULATION (continued)

R-31 Avg. Blown Insulation in Ceiling

****NOTE:** Spacing for Framing Members may vary due to Design Requirements

CUSTOMER CONTACT

Notes:
